

Energy Infrastructure Vessel

UT 7622 WP

Powered by Methanol

Charting a Course Towards Net Zero: Presenting the Fleet's Cleanest and Greenest Vessels

Reduced energy consumption

- Permanent magnet motors (thrusters)
- Rim drive thrusters (no reduction gears)
- Hull optimizations
(use of multi-parameter opt. software)
- HVAC technology and window/insulation
- Thermo-electric technology

*Based on typical operational profile:
-20% fuel consumption/emissions*

Total approx.
25-35%
reduction

in fuel consumption and emissions
by design features before introducing
alternative / renewable fuel(s)

Improved power generation efficiency

- Optimised Power & Propulsion solutions
with documented performance
- Application of Energy Storage Systems
(ESS) (spinning reserve, peak shaving/
load smoothing and full electric transit/
harbour operation)

*Based on typical operational profile:
-10% fuel consumption/emissions*

Reduced fuel consumption

- High power shore connection
- Fully electric operation
(in port / in and out of port)
- KM EcoAdvisor

*Based on typical operational profile:
-5% fuel consumption/emissions*

Vessel Specifications

UT 7622 WP Methanol Dual Fuel Subsea Construction IMR vessel (with Walk to Work option).

Registration	
Delivery date:	Q4 2025
Flag / Port registry:	Singapore
Class	DNV
Class notations:	⌘1A, Offshore service vessel, LFL Fuelled, COMF (V-3, C-3), E0, Cyber secure, Battery (power), ER(SCR, Tier III), Clean (Design, Tier III), NAUT(AW), Recyclable, BWM(T), DYNPOS(AUTR), HELDK(S, H), WALK2WORKREADY (option), STRENGTHENED(DK), CRANE, LCS, BIS
IMO no / Callsign:	TBC

Vessel Data	
Length Overall	104.4m
Length Between Perpendiculars	94.4m
Breadth Moulded	22.0m
Depth to Loadline Freeboard (Deck 3)	9.2m
Design Draught	6.2m
Draught Summer	6.7m
Scantling Draught	6.7m

Main Capacities	
Fuel Oil	500 m ³
Fuel Oil	900 m ³
Methanol	790 m ³
Ballast Water	2800 m ³
Fresh Water	230 m ³ - 375 m ³
Deck Cargo	2300 t
Deadweight	5000 t
Deck Area	~1000 m ²
Deck Strength	10 t / m ²

Accommodation (120 pax)	
Cabins	72 (24 Single, 48 Double)
Offices	3
Conference Room	1
Lounge / Day Room	3
Gym	1
Hospital	1 x Hospital type bed, 2 x Ambulance stretchers
All cabins fully air conditioned and with attached toilets, compliant with MLC 2006.	

Power Installation	DP Capability: L1(9,7,7,6)
Main Engines: ABC x 5	
2 x 2292kW at 900 rpm, 2 x 3057kW at 900 rpm, 1 x 2546kW at 1000 rpm	
Propulsion: 5,200kW	
2 x Permanent Magnet Azimuthing Thrusters @ 2600 kW each - Type Kongsberg AZ-PM 2600, or similar	
Bow thruster:	
2 x PMTT2000 tunnel thrusters 1600kW each 1 x TCNS 100 retractable azimuth thruster at 1600kW	
Emergency generators: TBC	

Performance				
Methanol Dual Fuel	Pilot Fuel t/day	Methanol t/day	Diesel (MDO) Fuel	MDO t/day
10 Kts	3.0	13.3	10 Kts	8.4 t/day
12 Kts	4.9	20.0	12 Kts	12.9 t/day
DP Ave N.Sea	2.2	10.6	DP Ave N.Sea	8.4
DP ROV Ave	4.4	20.3	DP ROV Ave	14.7
DP Crane Ave	4.5	20.8	DP Crane Ave	15.2
DP Crane & ROV Ave	6.1	26.8	DP Crane & ROV Ave	18.4

* Hotel load at 500 kW included. DP consumption at BF5, 50 deg heading.

** All speeds and consumptions without guarantee, speed and power measurements to be performed during sea trials

Deck Machinery and Mooring Equipment	
Anchors	2 stockless anchors installed in anchor pockets forward, SB and PS
Anchor chains	K3 steel stud link chain with dimensions and lengths according to class
Combined windlass / mooring	2 x 14t
Tugger winches	1 x 15t
Helideck	SOLAS Regulation II-2/18

Subsea Crane	
Model	150t heave compensation knuckle boom crane
Max hook travelling length	3000 m
Lifting capacity	42t at 30m radius - Subsea 150t at 9m radius Subsea
Slewing angle	360 degrees unlimited
Personal lift	1t

ROV Facilities	
ROV Facilities	<ul style="list-style-type: none"> - 2 x ROV hangars - ROV mechanical workshop - ROV online room, ROV offline room, data room/survey room
Moonpool	7.2m x 7.2m
LARS	with active heave compensation
Deck/Provisional crane 1 x Telescopic foldable deck crane – approx. 2 tonnes at 16m.	

Navigation and Communication Equipment	
GMDSS	Area 3 - 421 Radio Plant
DP System	DP Class II with all necessary equipment and reference system
Insarmat C	421 Radio Plant
VSAT system	4 telephone lines. Mobile Broadband internet connection system for inshore use min. 15 Mbps. Automatic switching between inshore and offshore mobile broadband network and VSAT (back-up) internet connection.

Emergency Rescue and Lifesaving Equipment	
Fast Rescue Boat	1 x 7 person
Rescue Boat	DP Class II with all necessary equipment and reference system
Life rafts, life buoys, life jackets, and immersion suits as per Flag State standards	

Optional Features	
Wind/SOV duties - Prepared for motion compensated gangway	
Prepared for installation of Trenching tools	
Prepared for Cable Lay services	

Images

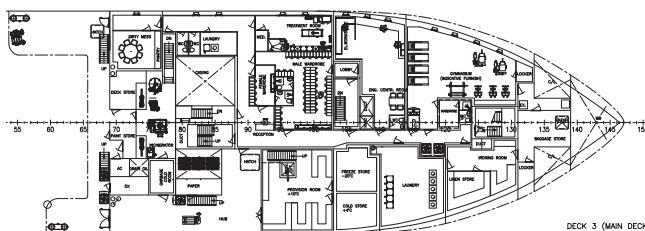
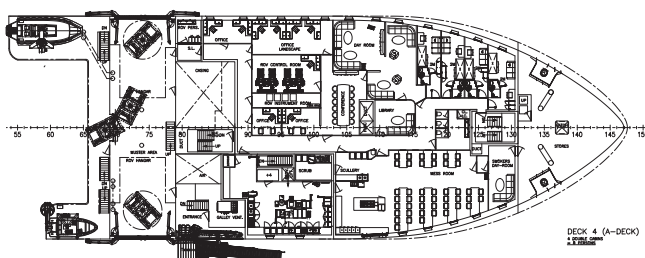
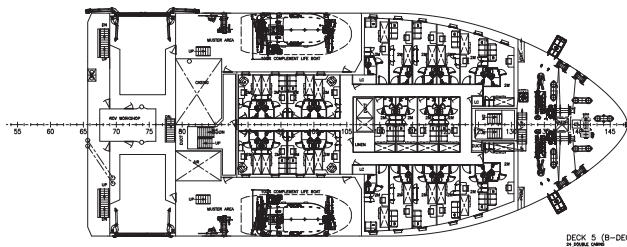
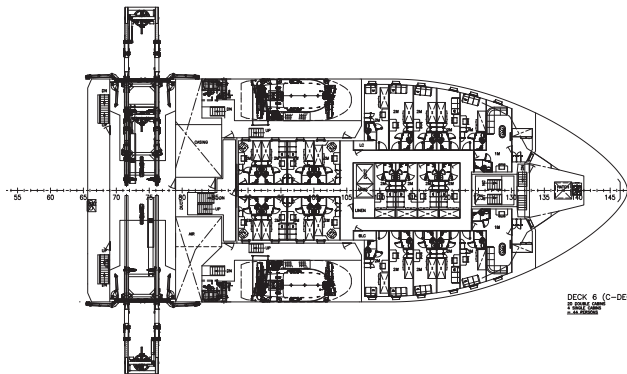
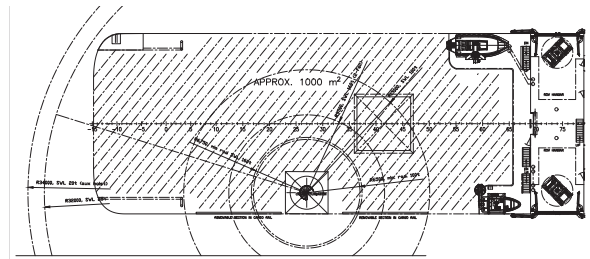
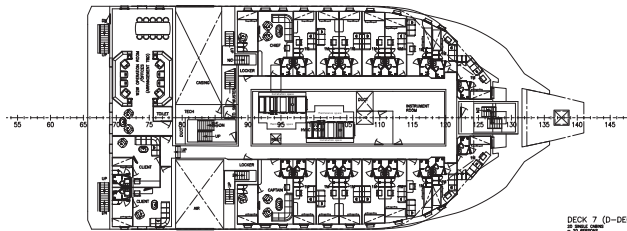
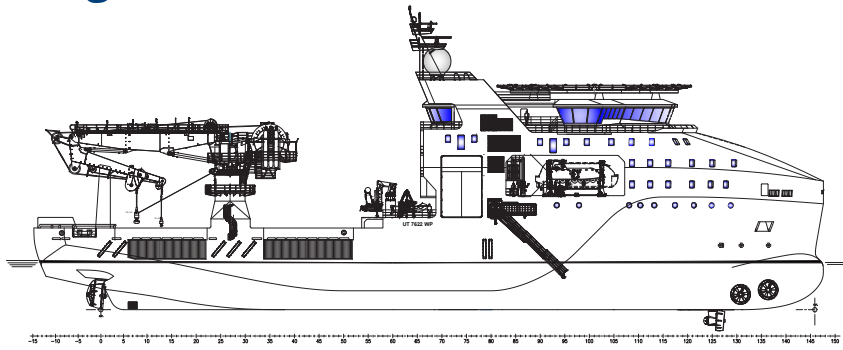

Images

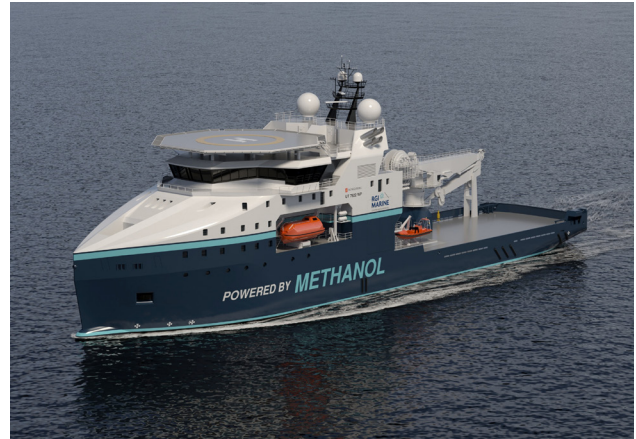

Energy Infrastructure Vessel
UT 7622 WP
Powered by Methanol

Images



Energy Infrastructure Vessel
UT 7622 WP
Powered by Methanol

Contact Details

RGI Marine Holdings Pte Ltd
03-02B, 90 Eu Tong Sen Street
Singapore, 059811

e: contact@rgimarine.com